

Lot	Area (sqm)	Area (sqft)
1-2	2227.54	16,832
3-4	2227.54	16,832
5-6	2227.54	16,832
7-8	2227.54	16,832
9-10	2227.54	16,832
11-12	2227.54	16,832
13-14	2227.54	16,832
15-16	2227.54	16,832
17-18	2227.54	16,832
19-20	2227.54	16,832
21-22	2227.54	16,832
23-24	2227.54	16,832
25-26	2227.54	16,832
27-28	2227.54	16,832
29-30	2227.54	16,832
31-32	2227.54	16,832
33-34	2227.54	16,832
35-36	2227.54	16,832
37-38	2227.54	16,832
39-40	2227.54	16,832
41-42	2227.54	16,832
43-44	2227.54	16,832
45-46	2227.54	16,832
47-48	2227.54	16,832
49-50	2227.54	16,832
51-52	2227.54	16,832
53-54	2227.54	16,832
55-56	2227.54	16,832
57-58	2227.54	16,832
59-60	2227.54	16,832
61-62	2227.54	16,832
63-64	2227.54	16,832
65-66	2227.54	16,832
67-68	2227.54	16,832
69-70	2227.54	16,832
71-72	2227.54	16,832
73-74	2227.54	16,832
75-76	2227.54	16,832
77-78	2227.54	16,832
79-80	2227.54	16,832
81-82	2227.54	16,832
83-84	2227.54	16,832
85-86	2227.54	16,832
87-88	2227.54	16,832
89-90	2227.54	16,832
91-92	2227.54	16,832
93-94	2227.54	16,832
95-96	2227.54	16,832
97-98	2227.54	16,832
99-100	2227.54	16,832

REVISION PLAN 270/2/98D

The Estate of James Conliffe-Layne

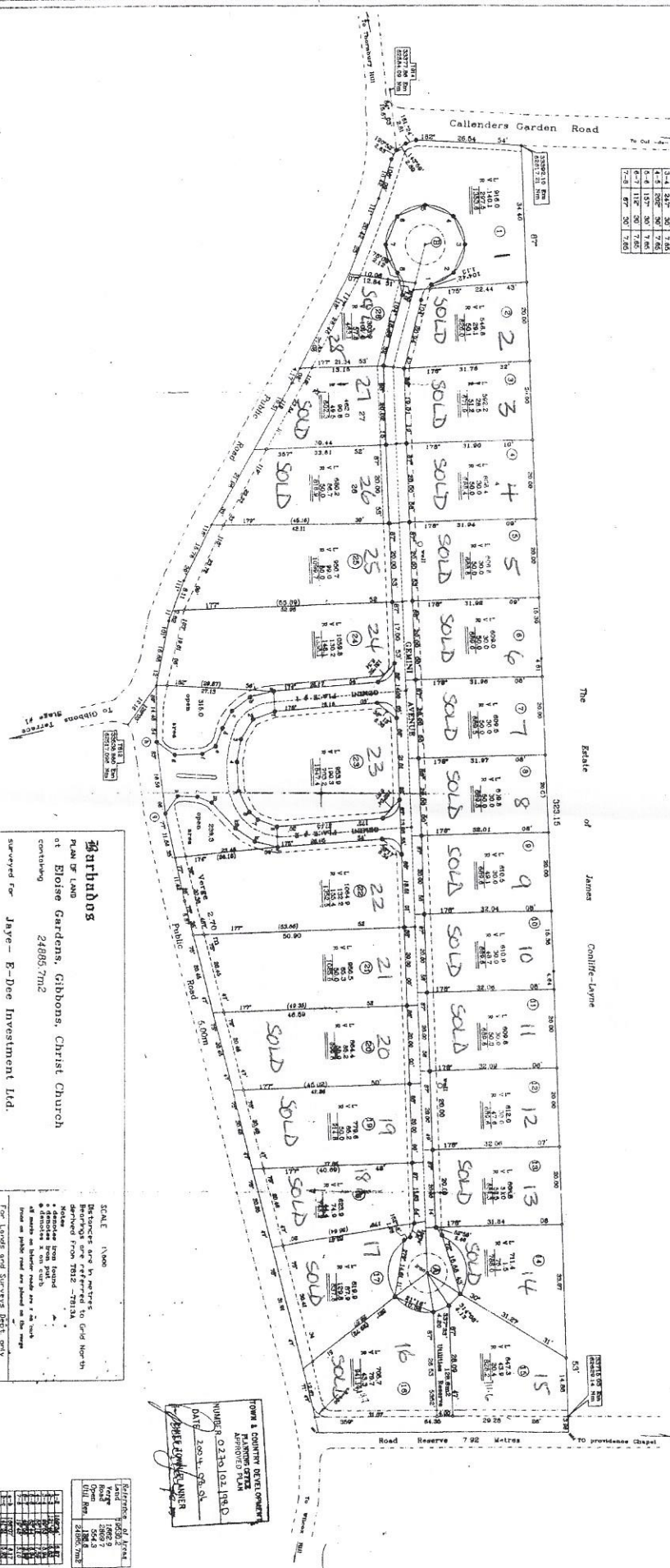

Garbados
 Plan of Land
 at Eioise Gardens, Gibbons, Christ Church
 containing
 24885.7m²
 surveyed for
 Jaye - E-Dee Investment Ltd.

SCALE: 1:5000
 Distances are in metres.
 Bearings are referred to Grid North
 and are rounded to the nearest 0.1.
 * distances from fixed
 monuments are in feet
 and are rounded to the nearest
 foot or half foot as shown on the map.
 For Lands and Surveys Dept only

FORM 1 CONTAINING REVISION PLAN APPROVED PLAN NUMBER 0210102198D DATE 2001/09/28

Lot	Area (sqm)	Area (sqft)
1	2227.54	16,832
2	2227.54	16,832
3	2227.54	16,832
4	2227.54	16,832
5	2227.54	16,832
6	2227.54	16,832
7	2227.54	16,832
8	2227.54	16,832
9	2227.54	16,832
10	2227.54	16,832
11	2227.54	16,832
12	2227.54	16,832
13	2227.54	16,832
14	2227.54	16,832
15	2227.54	16,832
16	2227.54	16,832
17	2227.54	16,832
18	2227.54	16,832
19	2227.54	16,832
20	2227.54	16,832
21	2227.54	16,832
22	2227.54	16,832
23	2227.54	16,832
24	2227.54	16,832
25	2227.54	16,832
26	2227.54	16,832
27	2227.54	16,832
28	2227.54	16,832
29	2227.54	16,832
30	2227.54	16,832
31	2227.54	16,832
32	2227.54	16,832
33	2227.54	16,832
34	2227.54	16,832
35	2227.54	16,832
36	2227.54	16,832
37	2227.54	16,832
38	2227.54	16,832
39	2227.54	16,832
40	2227.54	16,832
41	2227.54	16,832
42	2227.54	16,832
43	2227.54	16,832
44	2227.54	16,832
45	2227.54	16,832
46	2227.54	16,832
47	2227.54	16,832
48	2227.54	16,832
49	2227.54	16,832
50	2227.54	16,832
51	2227.54	16,832
52	2227.54	16,832
53	2227.54	16,832
54	2227.54	16,832
55	2227.54	16,832
56	2227.54	16,832
57	2227.54	16,832
58	2227.54	16,832
59	2227.54	16,832
60	2227.54	16,832
61	2227.54	16,832
62	2227.54	16,832
63	2227.54	16,832
64	2227.54	16,832
65	2227.54	16,832
66	2227.54	16,832
67	2227.54	16,832
68	2227.54	16,832
69	2227.54	16,832
70	2227.54	16,832
71	2227.54	16,832
72	2227.54	16,832
73	2227.54	16,832
74	2227.54	16,832
75	2227.54	16,832
76	2227.54	16,832
77	2227.54	16,832
78	2227.54	16,832
79	2227.54	16,832
80	2227.54	16,832
81	2227.54	16,832
82	2227.54	16,832
83	2227.54	16,832
84	2227.54	16,832
85	2227.54	16,832
86	2227.54	16,832
87	2227.54	16,832
88	2227.54	16,832
89	2227.54	16,832
90	2227.54	16,832
91	2227.54	16,832
92	2227.54	16,832
93	2227.54	16,832
94	2227.54	16,832
95	2227.54	16,832
96	2227.54	16,832
97	2227.54	16,832
98	2227.54	16,832
99	2227.54	16,832
100	2227.54	16,832

CERTIFIED 27 April 2004
 I, [Signature], Surveyor
 of the Land Surveyors
 of the [Province]