



BATTALEYS MEWS



MULLINS, BARBADOS

Sample Floor Plans and Estate Plan

BATTALEYS MEWS

MULLINS, BARBADOS

Estate Plan



BATTLEYS MEWS

MULLINS, BARBADOS

Ground Floor Plan

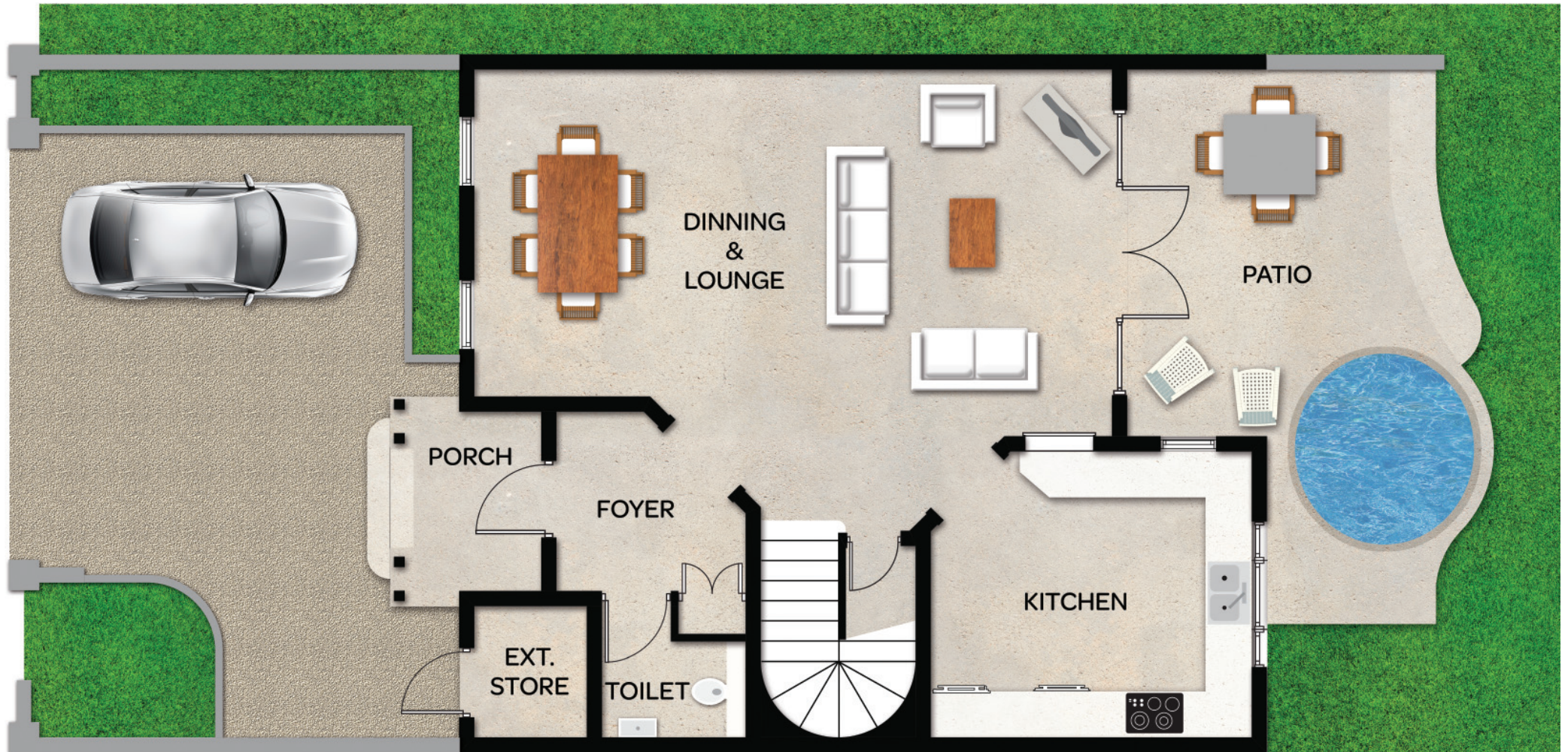

Ground Floor Area	= 1172 Sq. Ft.
Upper Floor Area	= 1182 Sq. Ft.
Total Floor Area	= 2354 Sq. Ft.

BATTALEYS MEWS

MULLINS, BARBADOS

Upper Floor Plan



Ground Floor

DINNING & LOUNGE	16'0" x 27'10"	444.7 sqft
EXT. STORE	5'8" x 4'11"	28.0 sqft
FOYER	8'3" x 7'10"	54.7 sqft
KITCHEN	14'1" x 12'6"	168.7 sqft
PATIO	11'7" x 16'2"	174.1 sqft
PORCH	6'7" x 9'2"	55.6 sqft
PW/RM	6'3" x 6'4"	32.6 sqft
S/CUP'B	8'0" x 3'0"	24.2 sqft

Upper Floor

BEDROOM 3	12'10" x 11'10"	151.3 sqft
BEDROOM 2	13'11" x 11'10"	164.4 sqft
LANDING	10'4" x 6'9"	70.0 sqft
MASTER BEDROOM	18'5" x 14'0"	257.6 sqft
EN-SUITE	10'5" x 14'0"	145.6 sqft
BALCONY	17'5" x 3'10"	67.1 sqft
BATHROOM	7'2" x 6'1"	43.8 sqft

BATTALEYS MEWS



MULLINS, BARBADOS

SALES

Chestertons
Flindt Building
1st Street
Holetown
St. James
Barbados W. I.

T. +1 (246) 432 2470

E. sales@battaleysmews.com

RENTALS

West Coast Villas
The Beach House
Holetown
St James
BB24016
Barbados W. I.

T. +1 (246) 432 2470

E. rent@battaleysmews.com

www.battaleysmews.com